

REPLACING A DAMAGED PLANK - OPTION A

If you choose to uninstall all the planks until you reach the damaged one, please consider the instructions on how to uninstall a 2G planks.

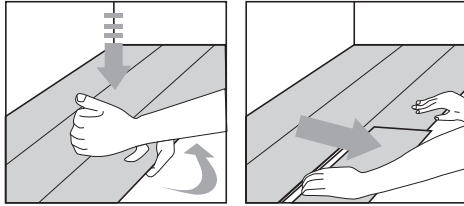

Lift the planks a few centimeters and tap along the long side joint. The released plank can then be slide out. However, never bend installed planks backwards, as this will damage the planks.

REPLACING A DAMAGED PLANK - OPTION B

If you choose to remove only the damaged plank, please consider the following instructions.

The following tools and materials are required in order to remove a plank from an installed area: Electric handsaw, knife, chisel, hammer.

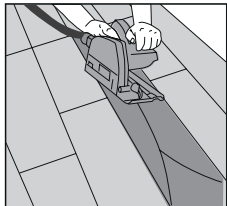

1

To remove the damaged plank you must cut it with a circular saw. Set the saw to the precise depth of the plank. Follow the cutting pattern as in the image.

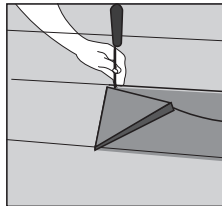

2

Use a wood chisel to remove one piece from a top.

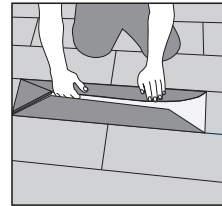

3

Remove the remaining short and long side pieces. Be careful while removing, not to damage the adjacent planks.

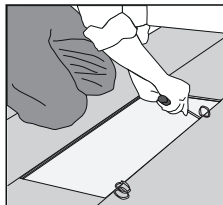
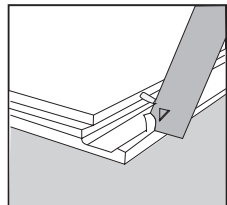

4

With a wood chisel, cut off the tongue on the short and long sides of the adjacent installed planks.

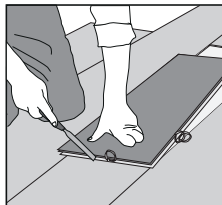

5

Repeat the cutting of the tongue (on the short and long sides) on the new plank.

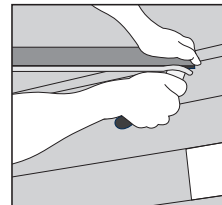

6

Remove the plastic bristle on the short side and cut off the locking groove rebound on the short and long sides of the new plank.

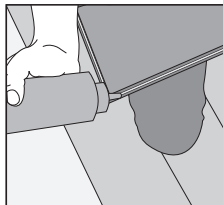
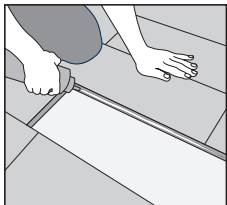

7

Apply a PVA D3 class adhesive on the short and long sides where you have cut the tongues. Apply on the adjacent installed planks, as well as on the new plank.

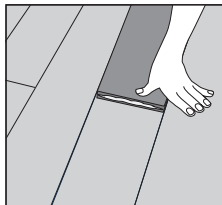

8

Slide the new plank into the place by inserting the side with groove first, using only manual pressure.

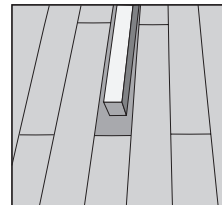

9

After the new plank is installed, place some weight on top while the adhesive dries. Avoid traffic immediately after to ensure perfect adhesion.